

Standard Type Hydraulic Garage Jack

9TYT132

- Double pump design for fast operation

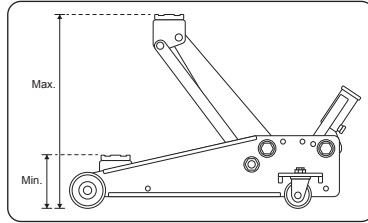
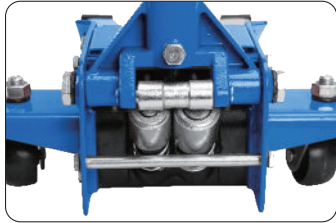

- Fast lifting dual pump

KT NO.	Capacity (T)	Min height (mm)	Max height (mm)	N.W (kg)	G.W (kg)	CUFT
9TYT132-03A-B	3	133	465	30.8	33.4	1.98

9TYT138

- Extra height adjustment for pad
- Extra carry handle for convenient transportation

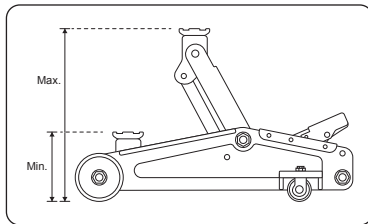

KT NO.	Capacity (T)	Min height (mm)	Max height (mm)	N.W (kg)	G.W (kg)	CUFT
9TYT138-03A-B	3	192	533	19.3	20.5	1.22

9TY132

- Foot pedal design for quick lift

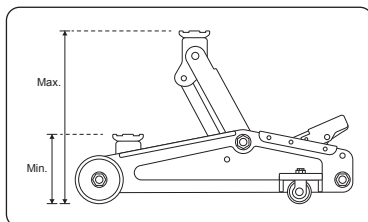

KT NO.	Capacity (T)	Min height (mm)	Max height (mm)	N.W (kg)	G.W (kg)	CUFT
9TY132A-35A-B	3.5	145	500	37.2	38.6	1.99