

1/2" DR. Damaged Nuts Remover Socket & Set



Can't be used with pneumatic wrench

9TD403

1/2"

- Made of top quality SNCM alloy steel, provide good wear resistance and durability
- Ideal for the removal of rounded, damaged or corroded nuts, bolts, oil drain plugs, marine nuts and bolts, exhaust manifold nuts, pipe nozzle, and studs
- No need for pounding, chisels or torches

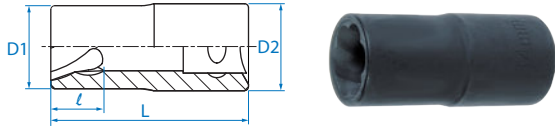

KT NO.	D1 mm	D2 mm	ℓ mm	L mm		
9TD403-10M	16.0	22	8	50	76	10 / 180
9TD403-12M	18.0	22	11	50	78	10 / 180
9TD403-13M	20.0	22	11	50	85	10 / 180
9TD403-14M	21.0	22	11	50	88	10 / 180
9TD403-17M	24.5	25	15	50	113	10 / 180
9TD403-19M	27.0	27	15	50	124	8 / 80
9TD403-21M	29.4	27	16	50	139	8 / 80
9TD403-22M	30.5	27	17	50	140	8 / 80
9TD403-23M	31.8	27	17	50	119	8 / 80
9TD403-24M	33.0	27	17	50	143	8 / 80
9TD403-27M	36.0	27	18	50	145	8 / 80

Roller Stud Extractor Socket & Set

9TD401

1/2"

- For tightening or loosening studs

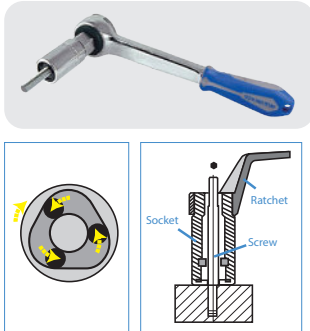

KT NO.	mm	D1 mm	D2 mm	L mm		
9TD401-06M	6	24.5	21	60	131	10 / 180
9TD401-08M	8	24.5	21	60	128	10 / 180
9TD401-10M	10	27.5	21	69.5	180	12 / 120
9TD401-12M	12	27.5	21	69.5	179	12 / 120

9TD014MR

1/2"

- 4 stud drivers for sizes M6, M8, M10 and M12

1.10 1 / 25

Blow case size (mm) :
210 x 111 x 49 (0.04CUFT)



4 PC.

9TD

1/2"



KT NO.	Contents		
9TD034MR	21, 22, 23, 27	0.58	4/36
9TD035MR	9TD403 12, 13, 14, 17, 19	0.52	
9TD036MR	10, 12, 13, 14, 17, 19	0.60	

Stud Remover Tool

9TD404-0619M

- Stud range: 6-19mm (1/4" - 3/4")
- Allows for easy removal of studs. Turn extractor with a ratchet, wrench or socket to engage the cam and stud, then pull out stud

0.64 1 / 24

